



Comprehensive School Safety Assessment Suite

Post Disaster Damage and Needs Assessment

Mobile digital toolset and methodology that allow school administrators and the education authority to rapidly conduct damage and needs assessments at schools after hazard impacts.

- Configurable to support rapid and slow-onset hazard impact episodes.
- Supports monitoring of multiple hazard episodes and their impacts in near-real-time.
- Offline and online mobile data collection is supported with data transfer over SMS or the Internet where/when available.
- PDDNA portal displays provisional summary statistics until survey is closed and final automated damage/needs reports at sub-national and national levels are released by the education authority.
- Users are authorized for different levels of access to information. At lower levels users can download and see school and aggregate damage/needs reports. At higher levels, some users may enter data, validate survey submissions, download data, run ad hoc queries or design custom automated reports to inform early response.
- Analysis of post-hazard archival data enables disaster preparedness and response planning.
- Deployed in 2022 by the Philippines Department of Education to service slow-onset hazard impact assessment efforts at over 45,000 schools as an integral part of DepEd's Disaster Risk Reduction Management Information System (DRRMIS), Rapid Assessment of Damage Reports (RADaR) initiative.

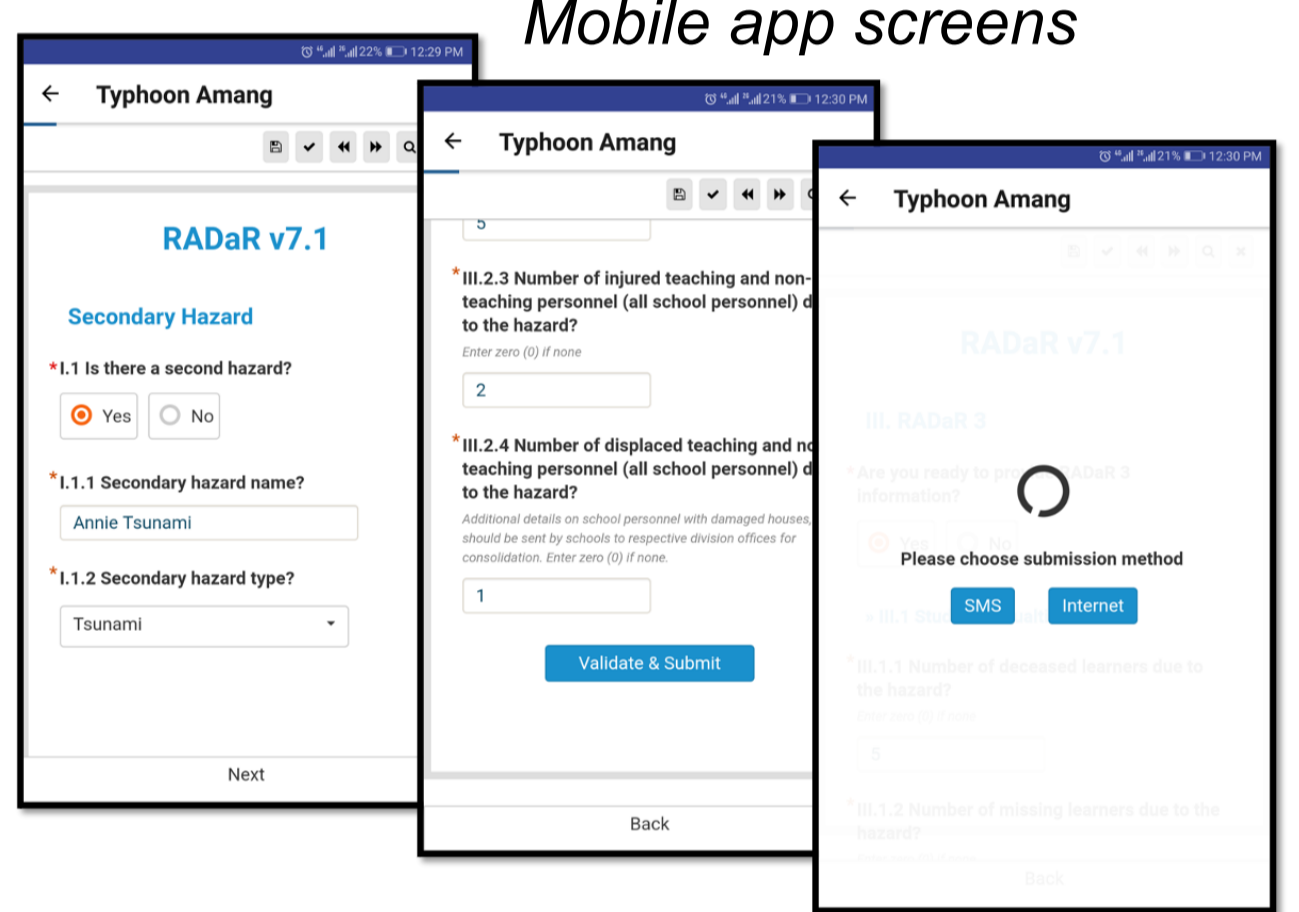
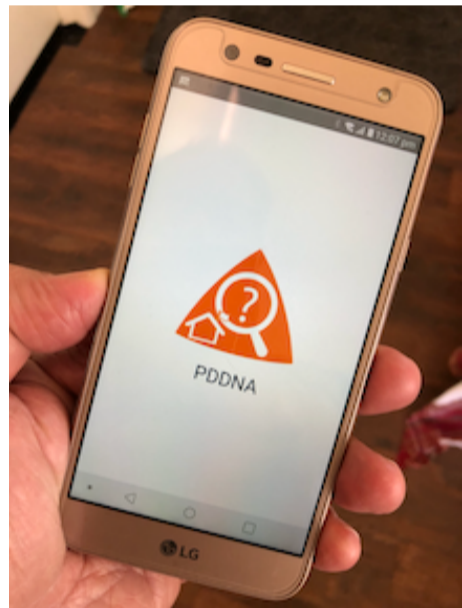

Mobile app screens

DRRMIS RADaR request via SMS

DRRMIS RADaR Invitation:
<http://rdr.app/5c2d7de0f7d97c4d53622feb/Amang/typ/01-01-1911%3A10>

Portal Dashboard

Hazard name, affected schools and learners.
 Classrooms with minor and major damage.
 Schools reporting, vetted and non-vetted reports

Damage/Needs Reports by Hazard
 Provisional and final at national, regional and school levels.

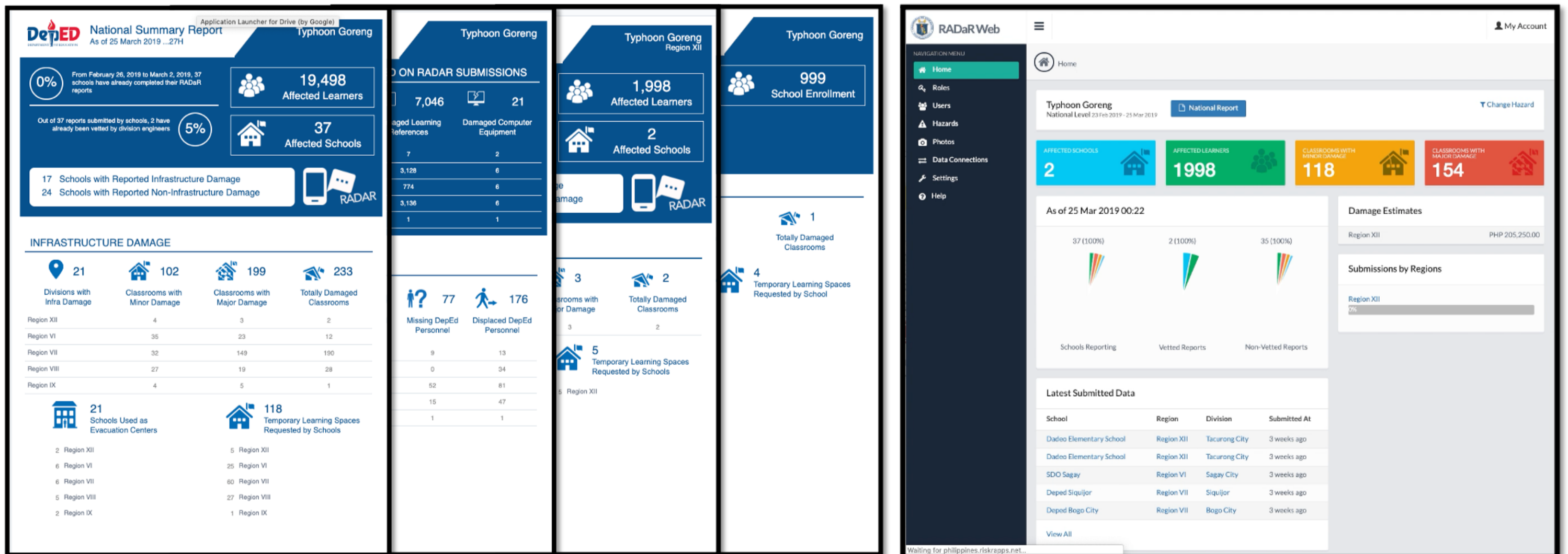

Find out more: Marla Petal (Save the Children) marla.petal@savethechildren.org.au

